

**vtech**<sup>®</sup>

User's Manual

# abc Spell with Me



© 2014 VTech  
**Printed in China**  
91-009684-002 

**VTech understands that a child's needs and abilities change as they grow and with that in mind we develop our toys to teach and entertain at just the right level...**

## **vtech** Baby

**Toys that will stimulate their interest in different textures, sounds and colours**

### **I am...**

...responding to colours, sounds and textures

...understanding cause and effect

...learning to touch, reach, grasp, sit-up, crawl and toddle

**Birth-36 months**

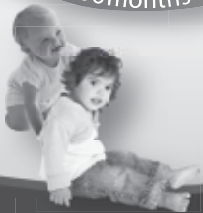

## **Pre-School**

**Interactive toys to develop their imagination and encourage language development**

### **I want...**

...to get ready for school by starting to learn the alphabet and counting

...my learning to be as fun, easy and exciting as can be

...to show my creativity with drawing and music so my whole brain develops

**3-6 years**



## **Electronic Learning Computers**

**Cool, aspirational and inspiring computers for curriculum related learning**

### **I need...**

...challenging activities that can keep pace with my growing mind

...intelligent technology that adapts to my level of learning

...National Curriculum based content to support what I'm learning at school

**4-10 years**



To learn more about this and other VTech® products, visit [www.vtechuk.com](http://www.vtechuk.com)

# INTRODUCTION

Thank you for purchasing the **VTech® abc Spell with Me!**

The **abc Spell with Me** allows your child to explore the world of letters, phonics, spelling and rhyming. Explore letters and their sounds one by one and build over 200 words. With an animated LCD screen to reinforce learning, plus fun sounds and melodies, there's always something new to discover with the **abc Spell with Me**.

30 LETTER BLOCKS:  
26 LETTER BLOCKS  
PLUS EXTRA  
d/e/m/o BLOCKS

4 ACTIVITY  
BUTTONS



ON/OFF  
BUTTON

LCD  
SCREEN

3 LED  
LIGHTS

HELP  
BUTTON

# INCLUDED IN THIS PACKAGE

- One VTech® abc Spell with Me
- 26 letter blocks plus extra d/e/m/o blocks
- One User's Manual

## WARNING:

All packing materials, such as tape, plastic sheets, packaging locks and tags are not part of this toy, and should be discarded for your child's safety.

**NOTE:** Please keep instruction manual as it contains important information.

Unlock the packaging locks:

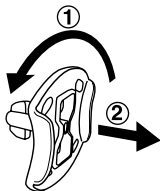

① Rotate the packaging lock counter-clockwise 90 degrees.

② Pull out the packaging lock.

CLASS 1  
LED PRODUCT

# GETTING STARTED

## RELEASE THE TRY-ME BLOCKS

1. Make sure the unit is turned **OFF**.
2. Carefully pull the try-me blocks away from the toy and cut the strings as illustrated.
3. Then, remove the strings from the front of the toy.
4. Please insert letter blocks (other than “d”, “o”, “g”) into the slot before you turn on the unit to activate normal play.



## BATTERY INSTALLATION

1. Make sure the unit is turned **OFF**.
2. Locate the battery cover on the bottom of the unit. Use a screwdriver or coin to loosen the screw.
3. Install 2 new “AA” size (LR6/AM-3) batteries following the diagram inside the battery box. (The use of new alkaline batteries is recommended for maximum performance.)
4. Replace the battery cover and tighten the screw to secure.

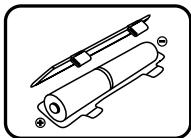

## BATTERY NOTICE

- Use new alkaline batteries for maximum performance.
- Use only batteries of the same or equivalent type as recommended.
- Do not mix different types of batteries: alkaline, standard (carbon-zinc) or rechargeable (Ni-Cd, Ni-MH), or new and used batteries.

- Do not use damaged batteries.
- Insert batteries with the correct polarity.
- Do not short-circuit the battery terminals.
- Remove exhausted batteries from the toy.
- Remove batteries during long periods of non-use.
- Do not dispose of batteries in fire.
- Do not charge non-rechargeable batteries.
- Remove rechargeable batteries from the toy before charging (if removable).
- Rechargeable batteries are only to be charged under adult supervision.

## PRODUCT FEATURES

### 1. ON / OFF BUTTON

Press the **On/Off Button** to turn the unit **ON**.  
Press again to turn the unit **OFF**.



### 2. ACTIVITY BUTTONS

Press the **Activity Buttons** to select an activity to play.



### 3. HELP BUTTON

Press the **Help Button** to hear the question or the corresponding hint.



## 4. 3 LED LIGHTS

Blinking **Lights** guide your child letter by letter.



## 5. 30 LETTER BLOCKS

Insert any of the **26 Letter Blocks** and **4 Extra d/e/m/o Blocks** to make a word or answer questions (in some modes).

To insert **Letter Blocks**:

- Place the **Letter Block** on the slot.
- Press down on the middle or bottom area of **Letter Block** to press it into unit.



If you do not receive a response after the letter block is inserted, please reinsert it.

## 6. VOLUME SWITCH

Switch the **Volume Switch** to adjust the volume.

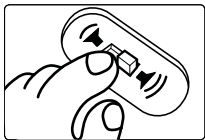

## 7. AUTOMATIC SHUT-OFF

To preserve battery life, the **VTech® abc Spell with Me** will automatically turn off after several minutes without input. The unit can be turned on again by pressing the **On/Off Button**.

# ACTIVITIES

## 1. PHONICS

Time to learn letters and phonics. Insert a **Letter Block** into any slot to hear the letter name and phonic sound.



## 2. LETTER ORDER

Watch carefully to see which letter is missing. Plug in the correct **Letter Block** to complete the correct letter order.



## 3. WORD EXPLORER

Put in 3 **Letter Blocks** to spell a word! Let's see how many word you can make.



## 4. SUPER SPELLER

Spelling time! The Spelling Bee will show a 3-letter word and a corresponding picture. Then plug in **Letter Blocks** to spell the word. After you spell several words successfully, you will automatically advance to a bonus round where you will spell rhyming words.





# CARE & MAINTENANCE

1. Keep the unit clean by wiping it with a slightly damp cloth.
2. Keep the unit out of direct sunlight and away from any direct heat source.
3. Remove the batteries when the unit is not in use for an extended period of time.
4. Do not drop the unit on hard surfaces and do not expose the unit to moisture or water.
5. Make sure the book pages are kept dry and flat.

# TROUBLESHOOTING

If for some reason the program/activity stops working or malfunctions, please follow these steps:

1. Turn the unit **OFF**.
2. Interrupt the power supply by removing the batteries.
3. Let the unit stand for a few minutes, then replace the batteries.
4. Turn the unit back **ON**. The unit will now be ready to play again.
5. If the product still does not work, replace with a new set of batteries.

If the problem persists, please call our Consumer Services Department on 01235 546810 (from UK) or +44 1235 546810 (outside UK) and a service representative will be happy to help you.

### **IMPORTANT NOTE:**

Creating and developing **VTech**<sup>®</sup> products is accompanied by a responsibility that we at **VTech**<sup>®</sup> take very seriously. We make every effort to ensure the accuracy of the information, which forms the value of our products. However, errors sometimes can occur. It is important for you to know that we stand behind our products and encourage you to call our Consumer Services Department on 01235 546810 (from UK), or +44 1235 546810 (outside UK) with any problems and/or suggestions that you might have. A service representative will be happy to help you

If you have a problem that cannot be solved by using this manual, we encourage you to visit us online or contact our Consumer Services Department with any problems and/or suggestions that you might have. A support representative will be happy to assist you.

Before requesting support, please be ready to provide or include the information below:

- The name of your product or model number (the model number is typically located on the back or bottom of your product).
- The actual problem you are experiencing.
- The actions you took right before the problem started.

**Internet:** [www.vtechuk.com](http://www.vtechuk.com)

**Phone:** 01235 546810 (from UK), or +44 1235 546810 (outside UK)

## **COPYRIGHT NOTICES:**

Copyright ©2014 **VTech**<sup>®</sup> Electronics Europe PLC. All Rights Reserved. **VTech**<sup>®</sup> and the **VTech**<sup>®</sup> logo are registered trademarks of **VTech**<sup>®</sup> Electronics Europe PLC. All other trademarks are property of their respective owners.

**Note:**

This equipment has been tested and found to comply with the limits for a Class B digital device, pursuant to Part 15 of the FCC Rules. These limits are designed to provide reasonable protection against harmful interference in a residential installation. This equipment generates, uses and can radiate radio frequency energy and, if not installed and used in accordance with the instructions, may cause harmful interference to radio communications. However, there is no guarantee that interference will not occur in a particular installation. If this equipment does cause harmful interference to radio or television reception, which can be determined by turning the equipment off and on, the user is encouraged to try to correct the interference by one or more of the following measures:

- Reorient or relocate the receiving antenna.
- Increase the separation between the equipment and receiver.
- Connect the equipment into an outlet on a circuit different from that to which the receiver is connected.
- Consult the dealer or an experienced radio/TV technician for help.

**Caution:** changes or modifications not expressly approved by the party responsible for compliance could void the user's authority to operate the equipment.



vtech®

## PRODUCT WARRANTY



Thank you for choosing this quality product from VTech. We hope it will bring many hours of entertainment, imaginative play and learning.

1. The product detailed above is covered by a one year warranty from the date of purchase, against any defects in materials or workmanship.
2. The product may be returned to the place of purchase. Alternatively the product can be returned to VTech Electronics Europe plc (see address below), with proof of purchase, without proof of purchase no replacement will be provided.
3. VTech Electronics Europe plc will examine the product and if it is found to be defective due to faulty materials or workmanship, will replace the product at their discretion.
4. If the product covered by this warranty is damaged due to misuse, modification or unauthorised repair, or because of faulty batteries, battery discharge or incorrect electrical connections, then this warranty becomes void.
5. This warranty is personal to the original purchaser and is not transferable.
6. Breakages to the LCD screen are not covered by the warranty.
7. Returns to VTech Electronics Europe plc should include a cheque or postal order for £1.50 towards the cost of return postage and packaging.
8. Products returned to VTech Electronics Europe plc, should be addressed as follows and packed carefully to avoid damage in transit (Please do not include batteries or adaptor).  
Please include details of the fault together with your name and address.

VTech Electronics Europe plc, c/o Tablogix Limited, 200 Milton Park, Abingdon, Oxon OX14 4TA

**THIS WARRANTY IS OFFERED AS AN EXTRA BENEFIT AND DOES NOT AFFECT CONSUMERS' STATUTORY RIGHTS.**

This warranty is valid for the UK and Eire only. For products purchased outside the UK and Eire, please contact your local distributor or place of purchase.

